

# DEKTITE ALUMINIUM

Dektite Aluminium is the best solution for pressed metal tiles. (Decramastic)

- 99.9% pure grade aluminium base
- Strong, malleable and easy to install
- No lead run off
- Ideal for potable water collection
- Withstands temperatures from -50°C to 115°C and up to 150°C intermittently



Code	Pipe OD (mm)	Base (mm)	Roof Pitch
TFA12-70	12-70	500 x 600	Up to 45°
TFA50-170	50-170	500 x 600	
TFA110-200	110-200	600 x 600	
TFA160-300	160-300	764 x 764	
TFA300-450	300-450	956 x 956	

## Installation instructions

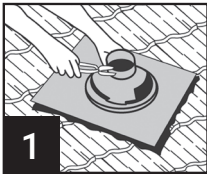

1 Trim Dektite cone to suit pipe size using sharp tin snips.

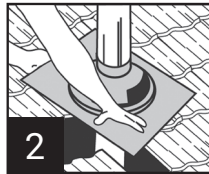

2 Lubricate flue with water, slide Dektite down to the tile level.

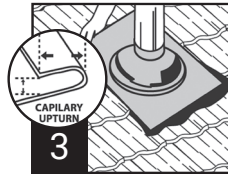

3 Form an anti-capillary fold. Place upper edge of base under up-stream tiles.

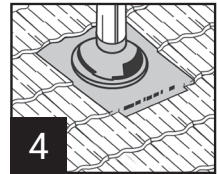

4 Dress base to profile. Cut tabs on the bottom corners and fold under to stop wind lift.